

02HON51156-V2-PEFC
Honeysuckle Playhouse



WARNING: Only for domestic use
Not suitable for children under 36 months due to small parts and danger of falling from heights.
To be used under direct supervision of an adult



BEFORE YOU START PLEASE THE READ INSTRUCTIONS CAREFULLY

- Check the pack and make sure you have all the parts listed in the parts list provided.
- When you are ready to start, make sure you have the right tools at hand (not supplied) including a Phillips screwdriver, Flathead screwdriver, Stanley knife, Wood saw, Step ladder, Hammer, Spirit level and a Drill with 2mm bit.
- Ensure there is plenty of space and a clean dry area for assembly.
- Ensure you have enough time to build the product to ensure the building is water tight.

TIMBER

As with all natural materials, timber can be affected during various weather conditions. For the duration of heavy or extended periods of rain, swelling of the wood panels may occur. Warping of the wood may also occur during excessive dry spells due natural processes. Unfortunately, these processes cannot be avoided but can be helped. It is suggested that the outdoor building is sprayed with water during extended periods of hot weather and sheltered as much as possible during rain or snow.

Our buildings are pre treated with a water based treatment**; this only helps to prevent discolouration whilst in stock. To validate your guarantee and ensure longevity of the product, it is ESSENTIAL the building is treated with a suitable preservative in accordance with the manufacturers recommendations. Care must be taken to ensure the product is placed on a suitable base. We recommended using a suitable protection for your playhouse. As the product is destined for use by children, a water based treatment that is **EN71 tested** for children is ESSENTIAL.

We also recommend treating the building prior to construction.

POSITIONING YOUR PLAYHOUSE

When thinking about where the building and base is going to be constructed:
Ensure that there will be access to all sides for maintenance work and annual treatment.

We recommend a **minimum space of 2m around a playhouse**, away from any structure or obstructions such as fences, garages, houses, overhanging branches, washing lines or electrical wires.

It is recommended that the position of the Playhouse, Slide and Swing is **not in direct sunlight**.

Activity toys such as swings and slides for towers shall not be installed over concrete, asphalt or any hard surface.

BUILDING A BASE

Ensure the base is level and is built on firm ground, to prevent distortion, checking with a spirit level. Refer to diagrams for the base dimensions. The base should be slightly smaller than the external measurement of the building, i.e. The cladding should overlap the base, creating a run off for water. It is also recommended that the floor be at least 25mm above the surrounding ground level to avoid flooding.

TYPES OF BASE

- Concrete 75mm laid on top of 75mm hard-core.
- Slabs laid on 50mm of sharp sand.
- Wooden base.



WARNING

- ONLY SUITABLE FOR DOMESTIC USE.
- TO BE USED UNDER DIRECT SUPERVISION OF AN ADULT.
- THIS PRODUCT SHOULD NOT BE MODIFIED IN ANY WAY. ANY MODIFICATIONS SHOULD BE DETERMINED BY THE MANUFACTURER AND CARRIED OUT ACCORDING TO THE INSTRUCTIONS.
- DO NOT ALLOW YOUR CHILD TO PLAY WITH ANY COMPONENT PARTS PRIOR TO ASSEMBLY.
- MAX AGE OF 14 YEARS.
- THIS TOY IS FOR OUTDOOR USE ONLY.
- USE A WATER BASED TREATMENT THAT IS EN71 TESTED



CAUTION

Wood is a natural product and can change post manufacture. So despite every effort being made to ensure the material used are cut and machined to a clean and smooth finish, care must be taken when handling the product and preparing for use by your child.

Any areas of concern, in the play areas, can be rubbed over with sandpaper to achieve a smoother finish. Alternatively, call the customer service department who will be happy to arrange replacement panels/parts.



All buildings should be erected by at least two adults.
DO NOT ALLOW CHILDREN TO ASSIST.



Winter = High Moisture = Expansion
Summer = Low Moisture = Contraction



To prevent damage during assembly, you **MUST** pilot drill all screw holes and **ensure all screw heads are countersunk.**



For ease of assembly, you will need a tape measure to check dimensions of components.

Whilst all products manufactured are made to the highest standards of Safety and in the case of childrens products independently tested to EN71, we cannot accept responsibility for your safety whilst erecting this product.

**Protim Aquatan T

Your building has been treated with **Aquatan**.

Aquatan is a water-based concentrate which is diluted with water, the building as been treated by the correct application of Aquatan solution and then allowed to dry.

Aquatan is a decorative finish to colour the wood, which is applied industrially to timber fence panels and garden buildings.

Aquatan undiluted contains: boric acid, sodium hydroxide 32% solution, aqueous mixture of sodium dioctyl sulphosuccinat and alcohols: 2, 4, 6-trichlorophenol.

**In all instances for assistance with your product, please contact customer care on :
01636 880514 or customerservice@merciagp.co.uk**

**Mercia Garden Products Limited,
Sutton On Trent,
Newark,
Nottinghamshire,
NG23 6QN**



Look for the symbols and follow the safety guidelines below.



Ensure screw heads are subflush and sand down any splinters created.



Ensure the screws are fixed squarely and do not protrude.



12mm gap surrounding the door.



50kg per user

Overall Dimensions:

Width = 1864mm
Depth = 1695mm
Height = 1711mm

Base Dimensions:

Width = 1760mm
Depth = 1670mm

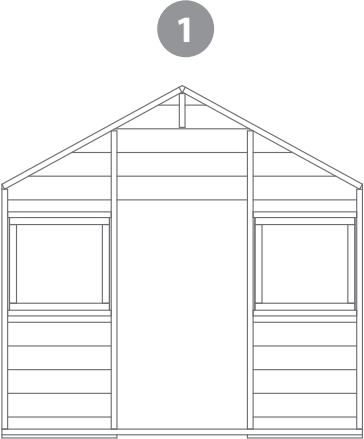
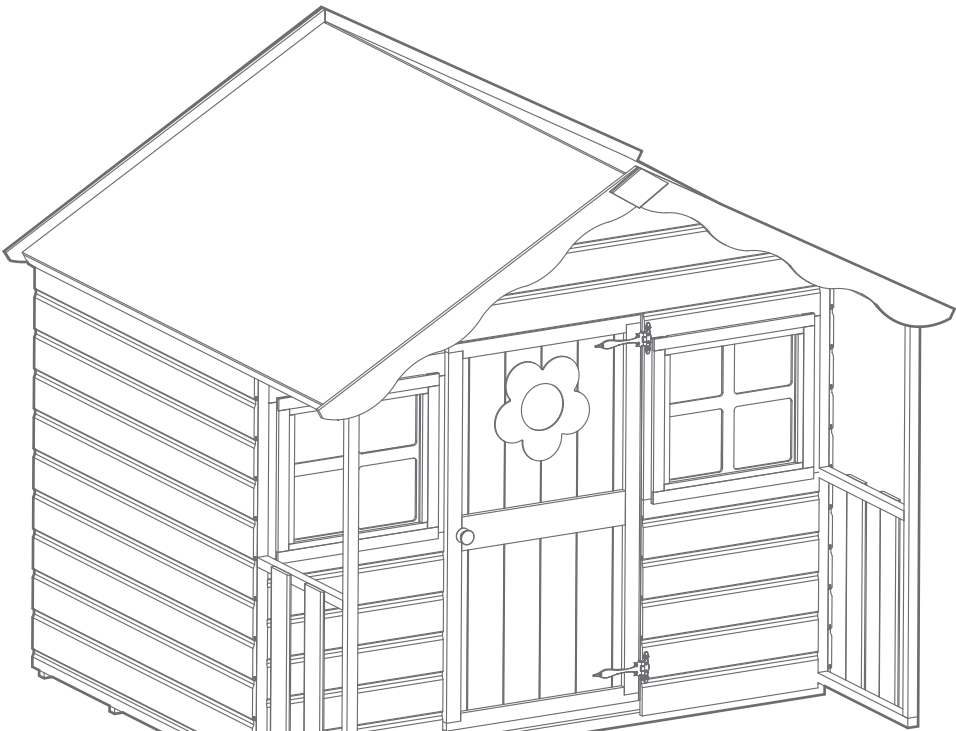

Door Gable
AI-01HON1156-V1DG

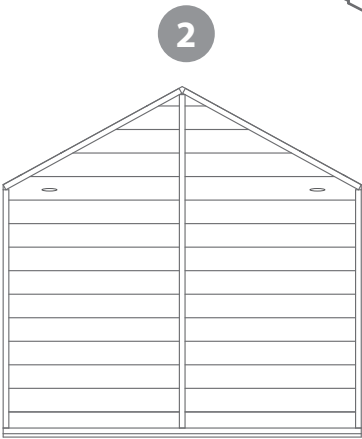

Plain Gable
AI-01HON1156-V1PG

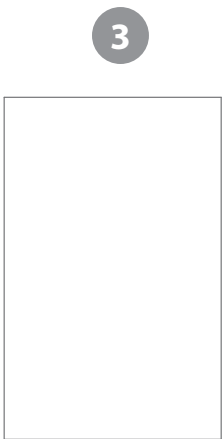

Roof OSB
1670x1060mm
PI-03-0018
QTY x2

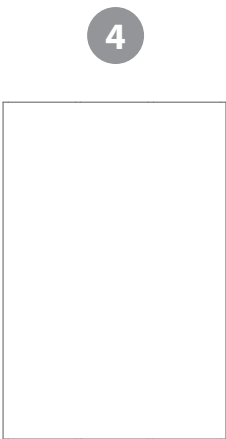

Floor Sheet
1760x1165mm
PI-03-0025

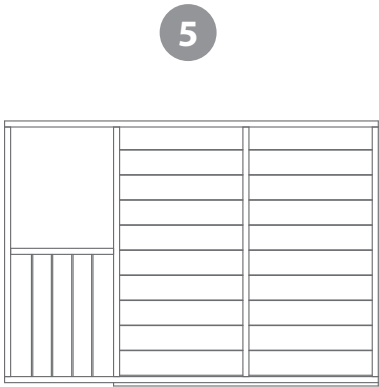

Left Side Panel
AI-02HON51156-V1LP

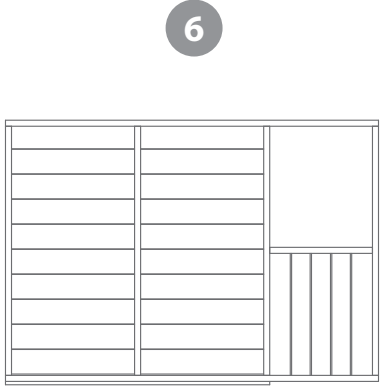

Right Side Panel
AI-02HON51156-V1RP

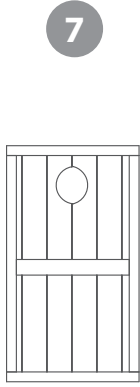

Door
AI-02HON51156-V1D

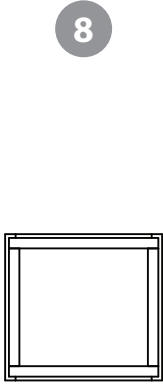

Window
AI-02PHOW-V1
QTY x2



Roof Eaves - 1670mm QTY x2 FS2828-1670mm

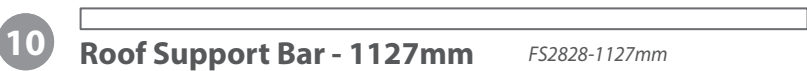

Roof Support Bar - 1127mm FS2828-1127mm



Floor Joist - 1760mm QTY x4 FS2828-1760mm

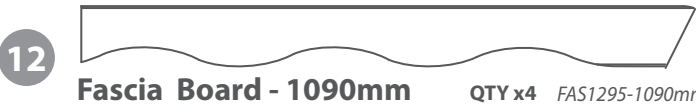

Fascia Board - 1090mm QTY x4 FAS1295-1090mm



Fascia Block
FS2828-240



Ply Door Stop
PLY TRIANGLE



Finial QTY x2
SHED DIAMOND FINIAL



Window Cross QTY x2
PI-04-0013



Door Flower
PI-04-0016



Door Styrene
PI-05-0014

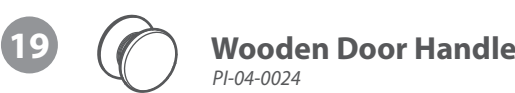

Wooden Door Handle
PI-04-0024

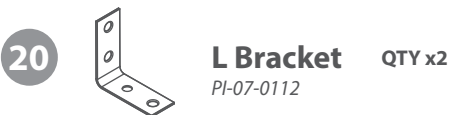

L Bracket QTY x2
PI-07-0112

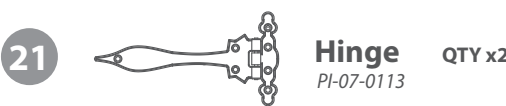

Hinge QTY x2
PI-07-0113



Window Block QTY x4
PI-07-0011

DO NOT ALLOW YOUR CHILD TO PLAY WITH ANY COMPONENT PARTS PRIOR TO ASSEMBLY.

Nail Bag

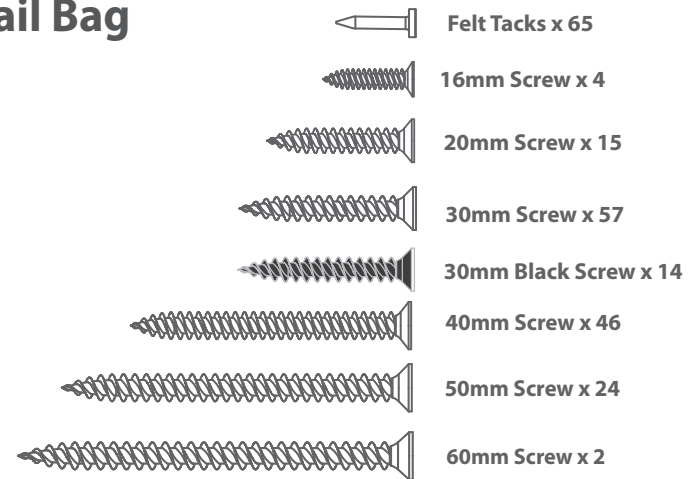

Pre Assembly

Before assembling remove the transportation blocks from the bottom of each panel.

Take care removing the blocks as to not damage the panels. Tap with a flat headed screwdriver and hammer.

Dispose of the blocks once removed.

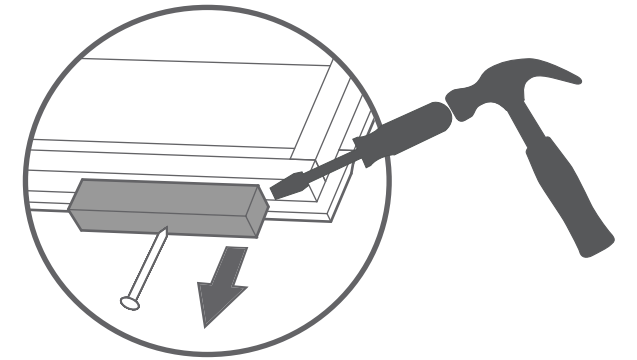

Step 1**Parts needed - 8 x2 & 22 x4**

A To fix the Windows into the panels that accomodate a window. Position the Window x2 (**No. 8**) central into the window opening. Fix the Window Block x8 (**No. 22**) to the Window central as shown with 1x30mm screw.

B Place the Window into the window hole and fix by screwing through the Window Block with 2x30mm screws as shown.

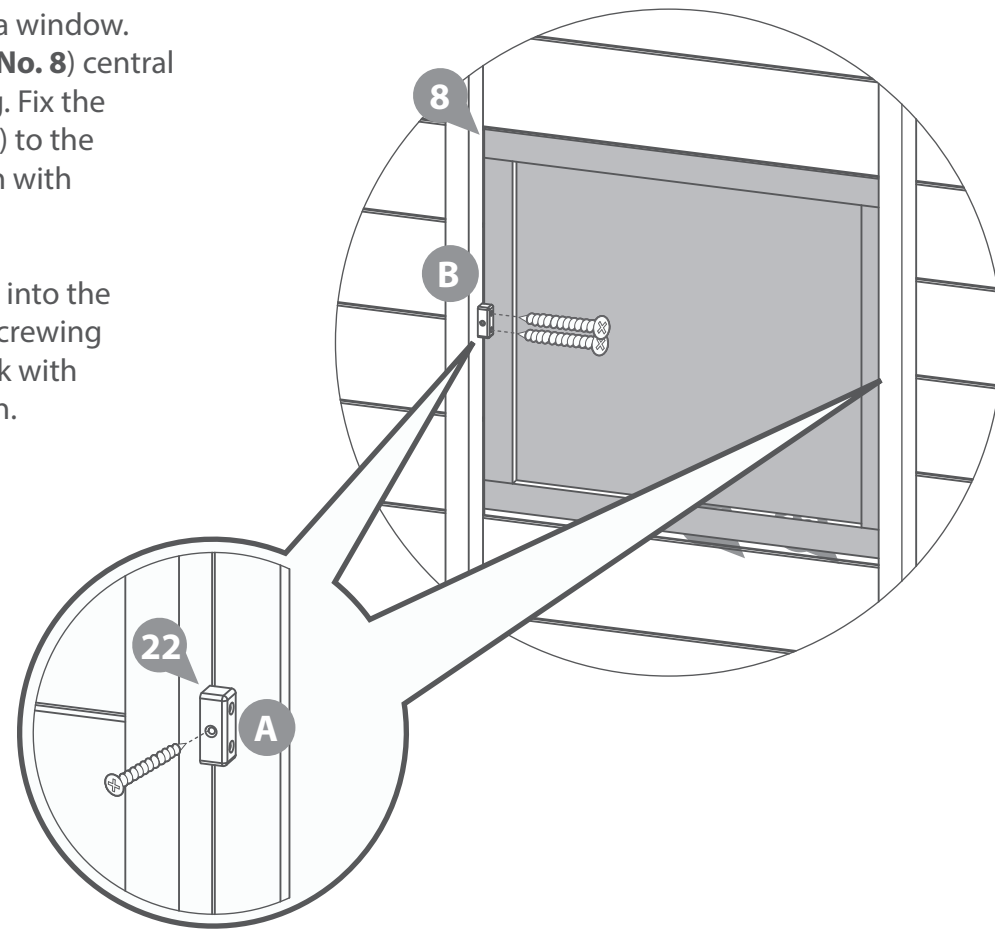
18x30mm screws.**Step 2****Parts needed - 4 & 11 x4**

If purchased with a tower please read both sets of instructions before beginning assembly.

Lay Floor Joists (**No. 11**) under the Floor Sheet (**No. 4**) with an even space between each one. Position joists flush on one side of the floor sheet and mark centers of joists onto either end.

Fix using 5 x 30mm screws per joist.

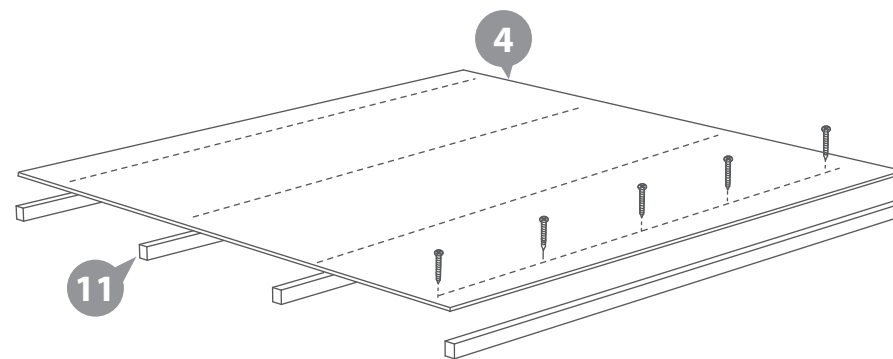
20x30mm screws.**Step 3****Parts needed - 1 & 7 & 21 x2**

A Lay the Door Gable (**No. 1**) face up on a flat surface, place the Door (**No. 7**) within the door aperture. Position the door so that you have a 12mm gap from the door to the door gable on all four sides as shown.

Useful tip: Use a 12mm thick piece of timber from your fixing kit within the gaps to ensure the door does not move.

B Once you are happy the door is in the correct position, place a Hinge (**No. 21**) at the top and bottom of the door, ensuring the screws will go into the framing (in cases where you have been supplied three hinges use the third in the middle of the door). Fix the hinge to the Door and the Door Gable using 7x30mm black screws per hinge.

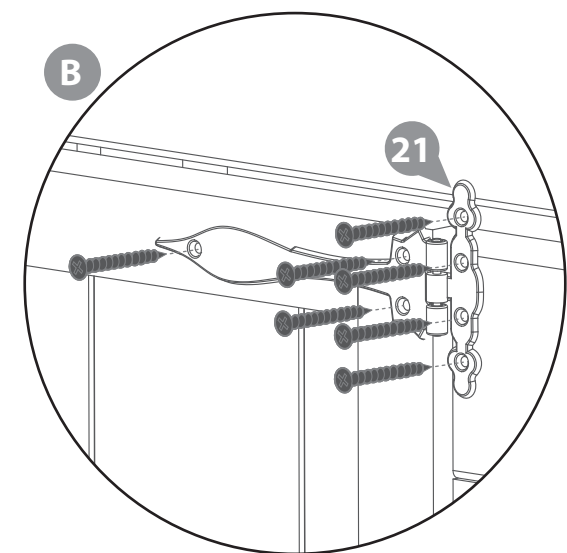
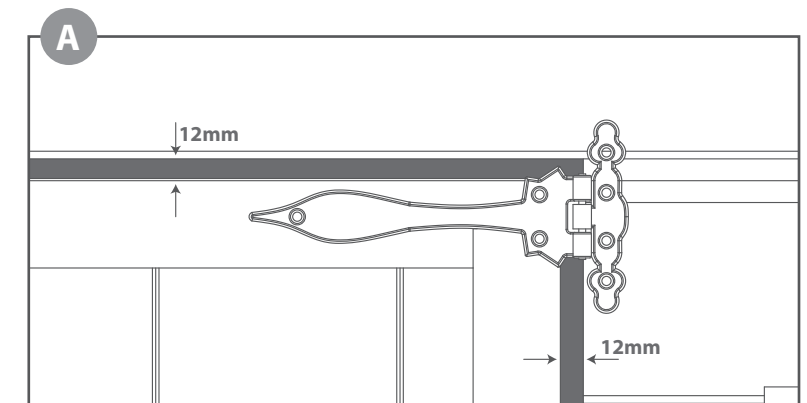
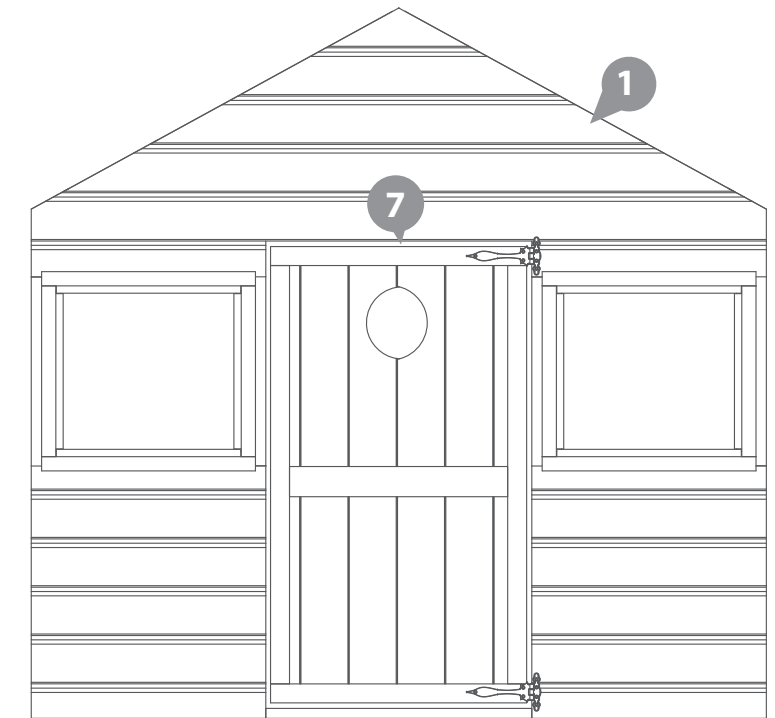
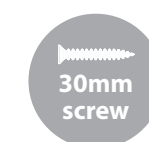
14x30mm black screws

DO NOT ALLOW YOUR CHILD TO PLAY WITH ANY COMPONENT PARTS PRIOR TO ASSEMBLY.

Step 4

Parts needed - 2 & 6

Fix the corner of the Plain Gable (No. 2) to the Right Side Panel (No. 6) with 3x 50mm screws as shown in diagram.

Do not secure the building to the floor until the roof is fitted.

3x50mm screws.

50mm screw

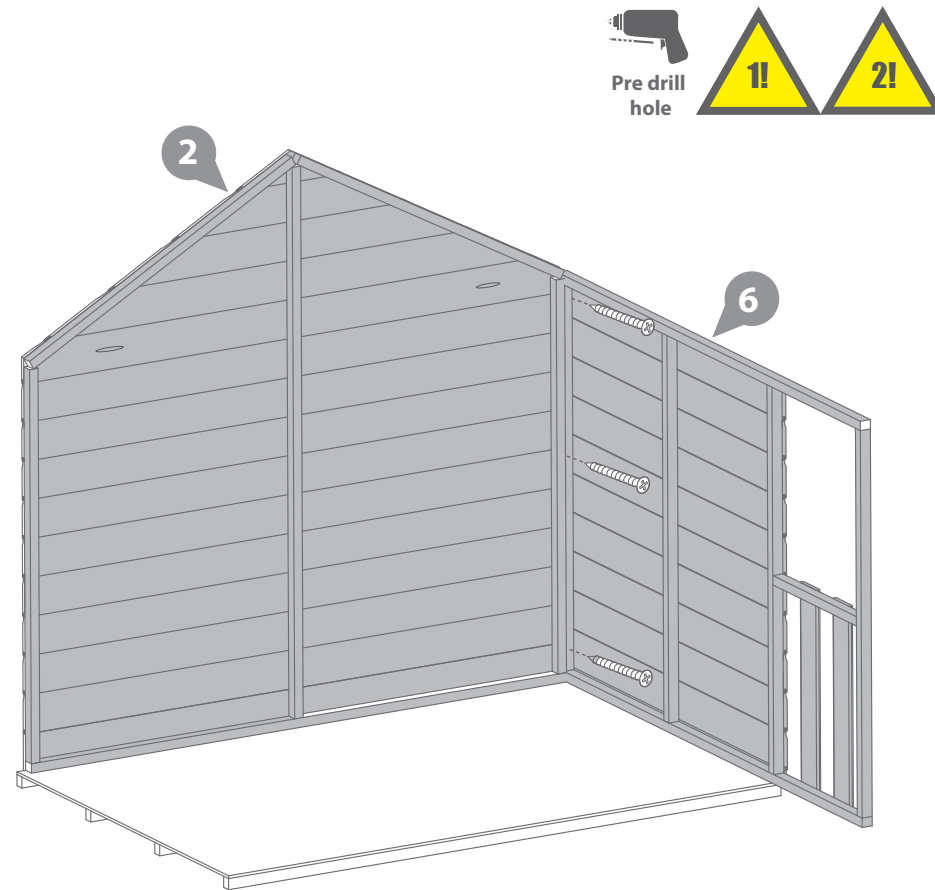

Step 6

Parts needed - 10 & 20 x2

Place the Roof Support bar (No. 10) in between the Door Gable and Plain Gable panels.

Ensure the top corners of the support bar are flush with each top point. Secure in place using the L Bracket (No. 20) on each end with 4x30mm screws per bracket.

Do not secure the building to the floor until the roof is fitted.

8x30mm screws.

30mm screw

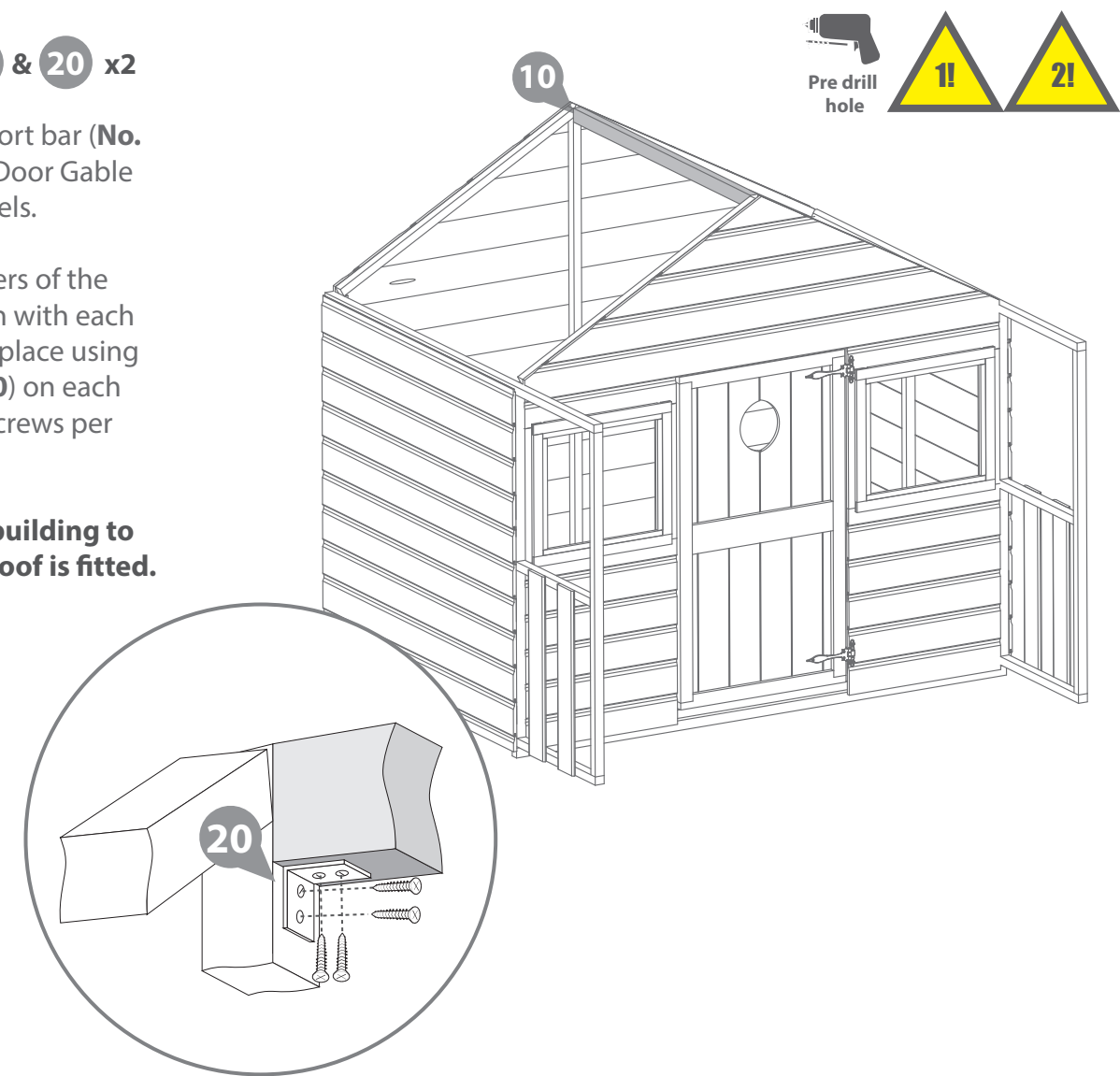

Step 5

Parts needed - 1 & 2 & 5 & 6

Fix Door Gable (No. 1) to the Right Side Panel (No. 6) and the Left Side Panel (No. 5). Then fix the Left Side Panel to the Plain Gable in the corners using 9x50mm screws.

Position the panels so there is equal spacing between the floor and cladding on all four sides.

Do not secure the building to the floor until the roof is fitted.

9x50mm screws.

50mm screw

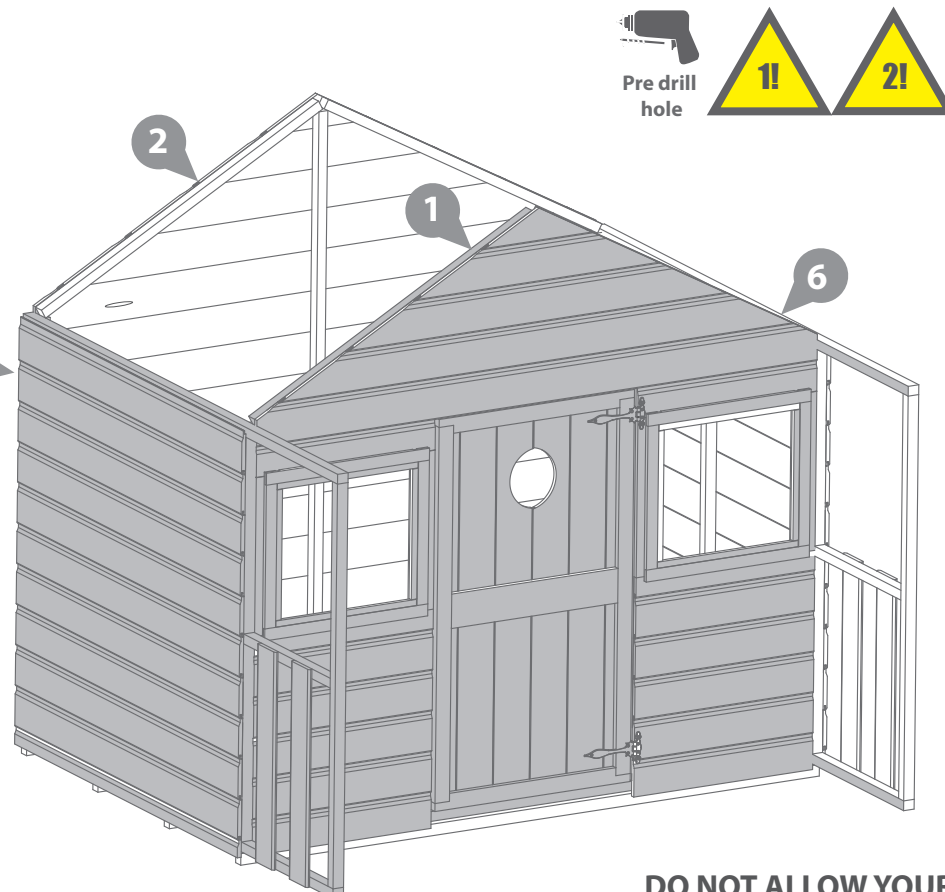
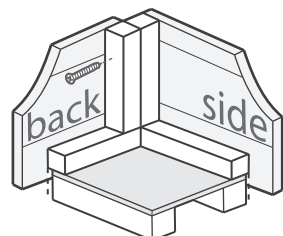

DO NOT ALLOW YOUR CHILD TO PLAY WITH ANY COMPONENT PARTS PRIOR TO ASSEMBLY.

Step 7

Parts needed - **3** x2 & **9** x2

A Fix the Roof Eaves x2 (**No. 9**) to each sheet using 3x30mm screws per eave.

B Fix the Roof OSB x2 (**No. 3**) to the roof using 13x40mm screws per sheet directly through the OSB into the framing.

Do not secure the building to the floor until the roof is fitted.

6x30mm screws.
26x40mm screws.

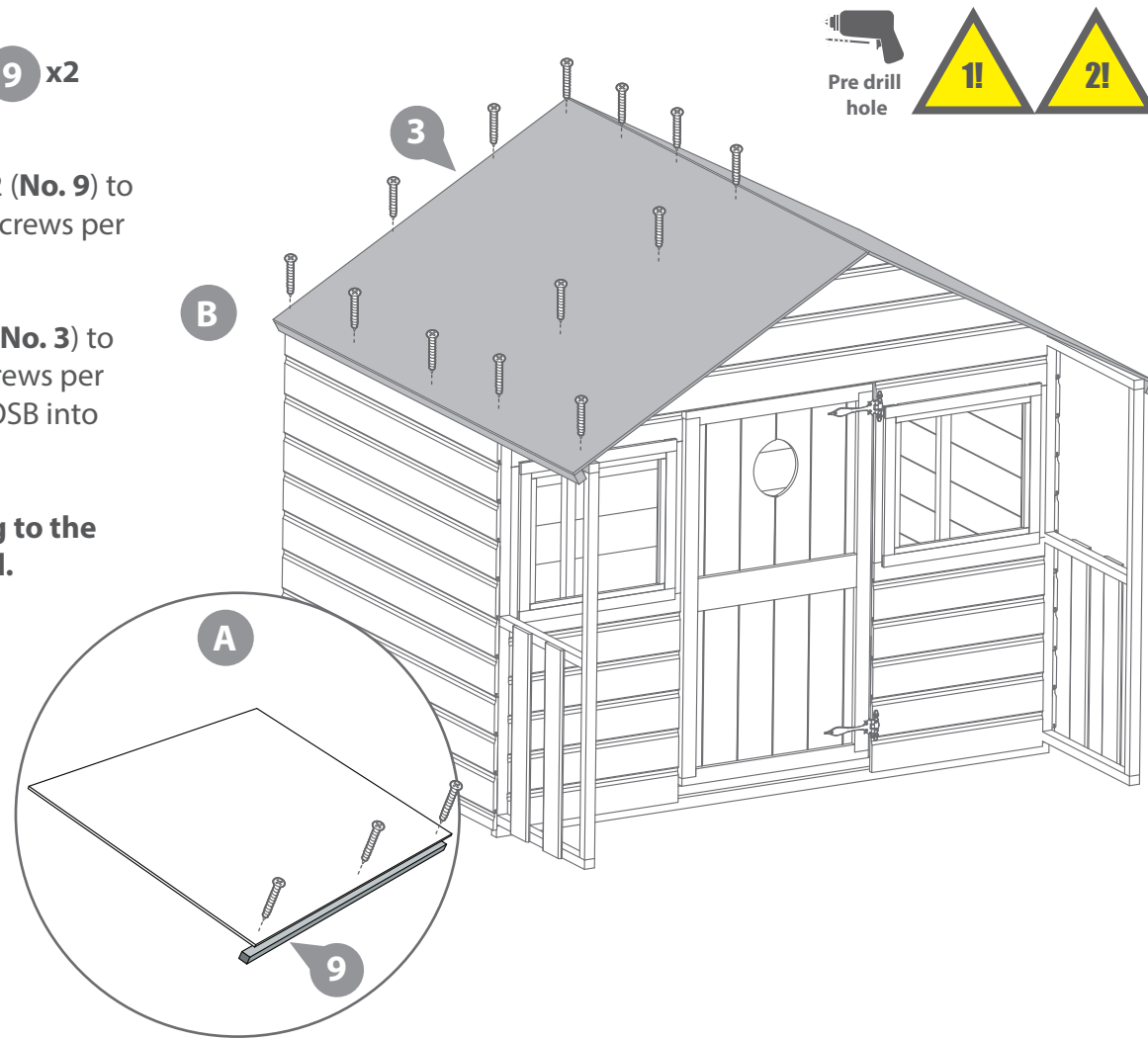

Step 9

Cut the Felt into 3 sheets of 1795 mm and lay onto roof as shown in diagram ensuring there is a 50mm overhang around the sides.

Fix using felt tacks at 100mm intervals.

60x Felt tacks

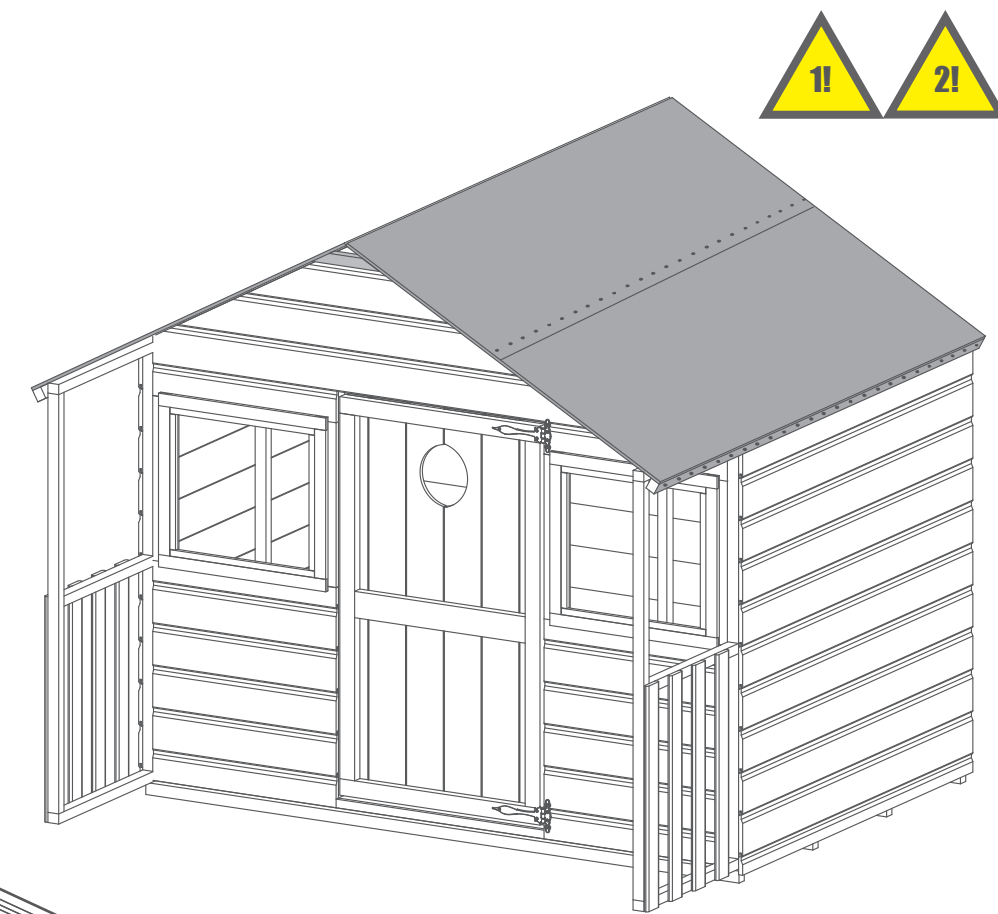
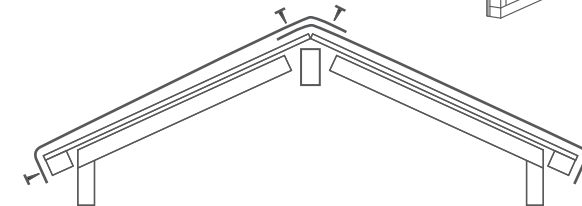
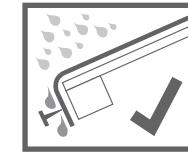

Step 8

Parts needed - **13**

Fit the Fascia Block (**No. 13**) to the front of the building using 4x30mm screws, make sure it is flush with the outside edge of each roof sheet.

4x30mm screws.

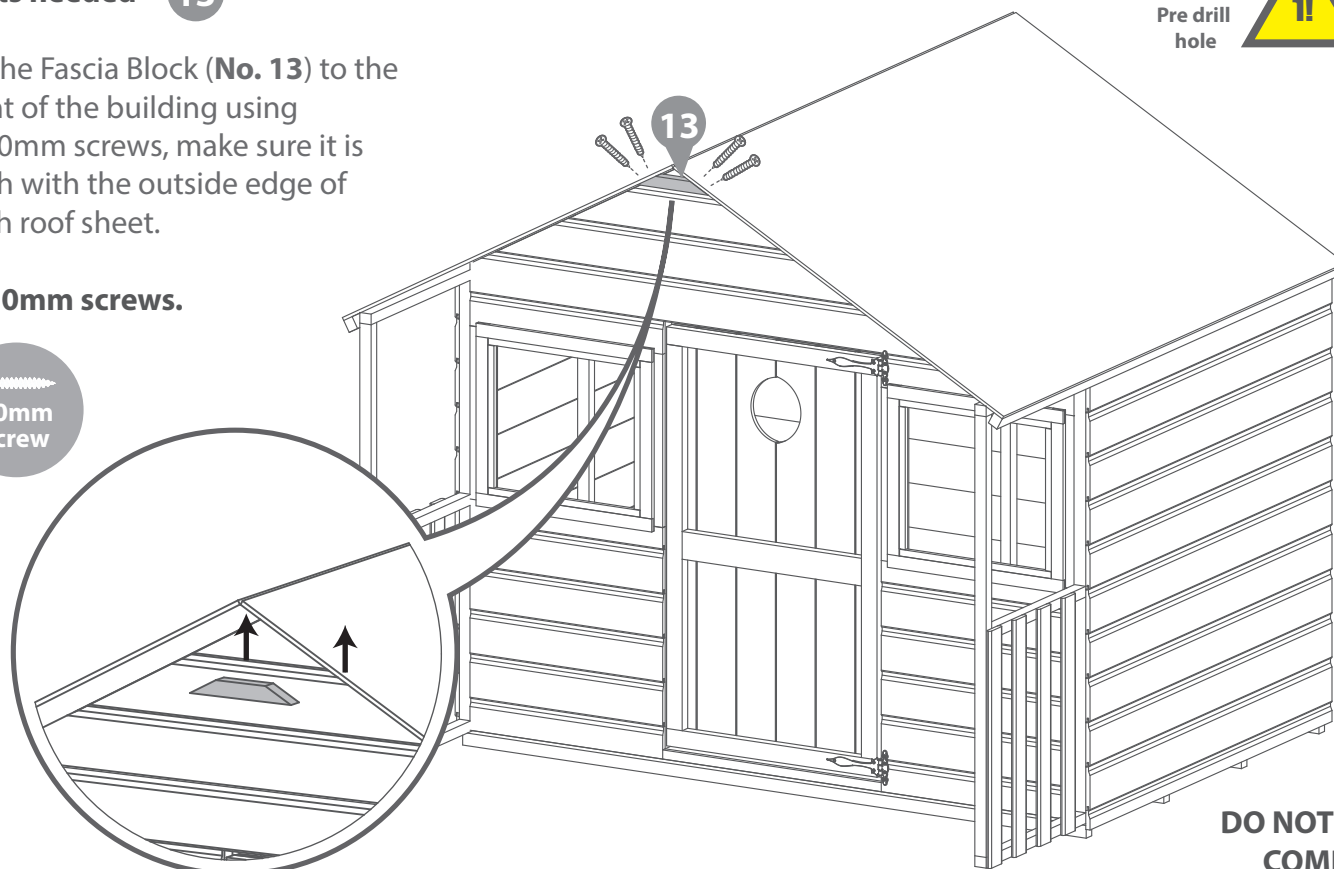

Step 10

Parts needed - **12** x4 & **15** x2

At the front and back of the building, fix the Fascia Board x4 (**No. 12**) and Finials x2 (**No. 15**). Fix the Fascia Board using 4x40mm screws per board and the Finials using 2x40mm screws each.

Ensure to trap the felt between the fascia and building.

20x40mm screws.

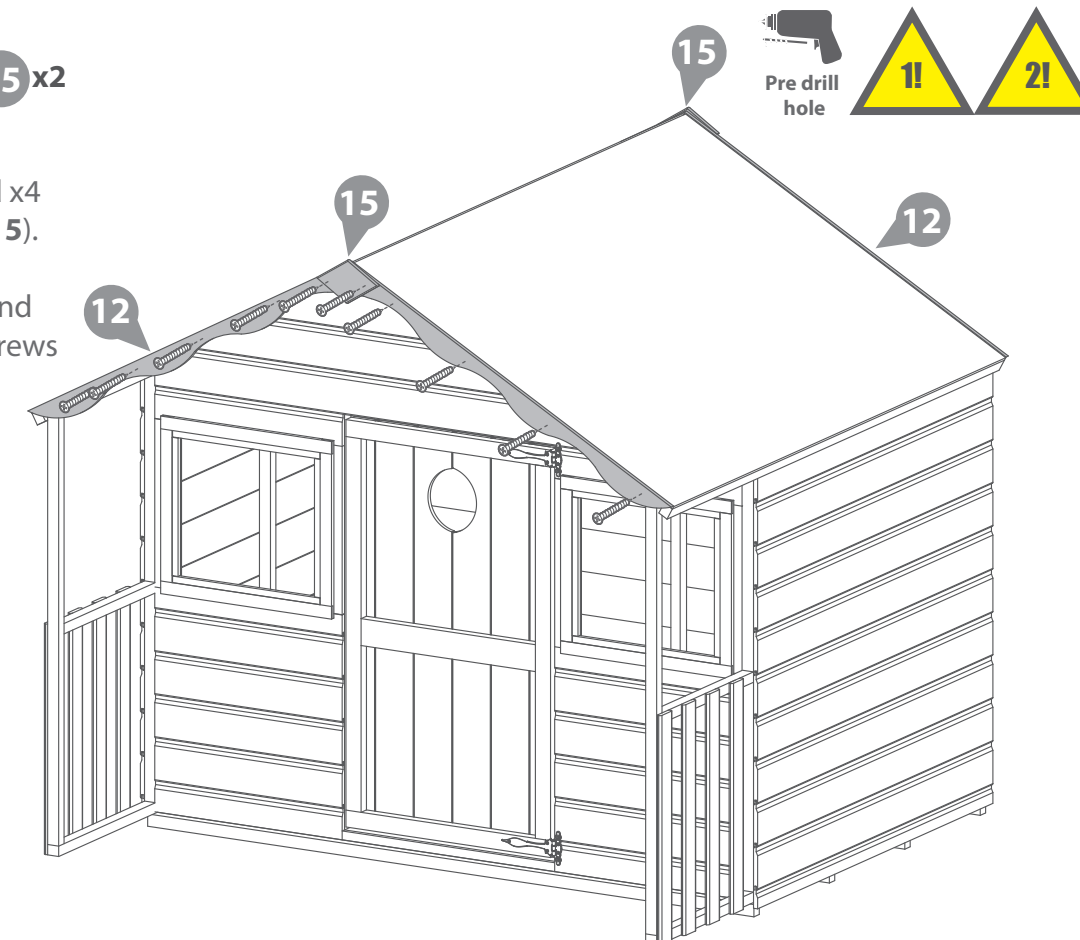
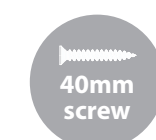

DO NOT ALLOW YOUR CHILD TO PLAY WITH ANY COMPONENT PARTS PRIOR TO ASSEMBLY.

Step 11

once the roof is fitted secure the building to the floor with 12x50mm screws

12x50mm screws.

50mm screw

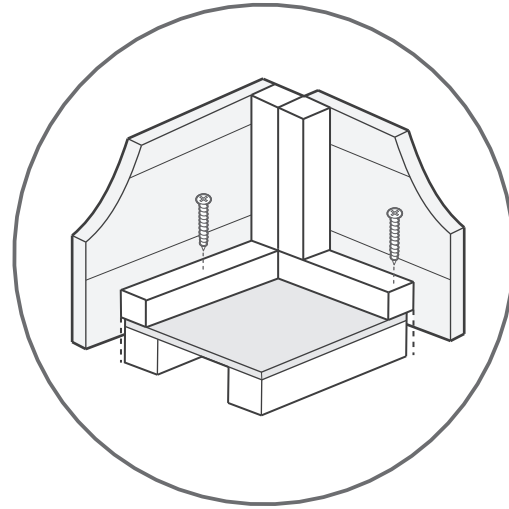

d On the inside of the door opening, fix the Ply Door Stop (**No. 14**) to the bottom left corner using 3x20mm screws.

3x20mm screws

60mm screw

20mm screw

10mm screw

d

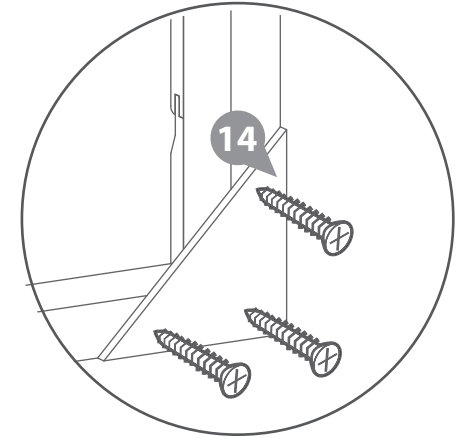

Step 12

Parts needed - **14** **16** x2 & **17** **18** **19**

a Place a Window Cross (**No. 16**) against the inside of each window. Position the frame centrally to the window and fix using 4x20mm screws per frame.

8x20mm screws

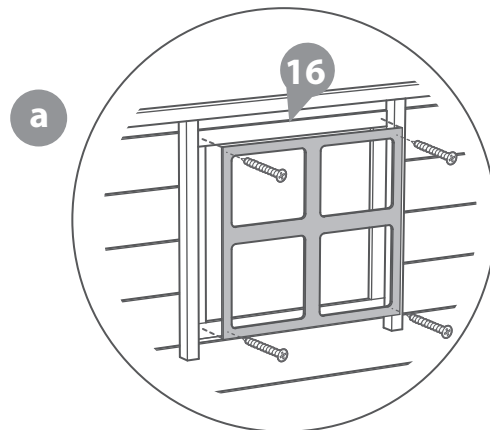

b Place the Wooden Door Handle (**No. 19**) on the outside of door and use a 60mm screw from the inside to secure.

1x60mm screws

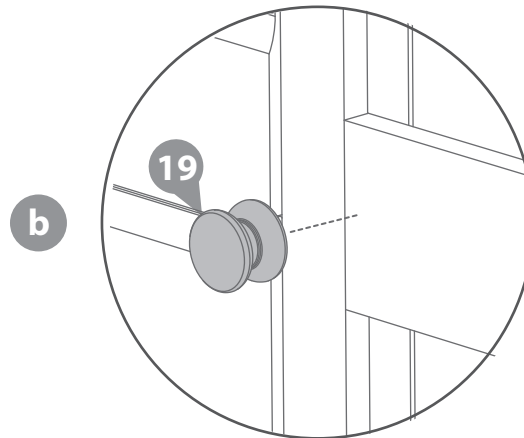

c Sandwich the Door Styrene (**No. 18**) between the door cut out and Door Flower (**No. 17**), then fix using 3x16mm screws. Ensure the glazing covers the cut out and the screws do not crack the glazing.

3x16mm screws

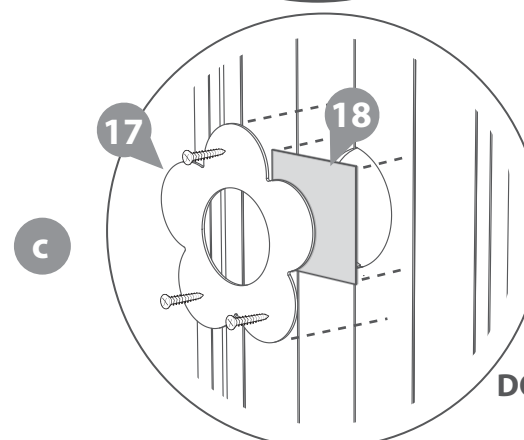

It is **ESSENTIAL** that you apply wood treatment immediately after the building has been assembled.

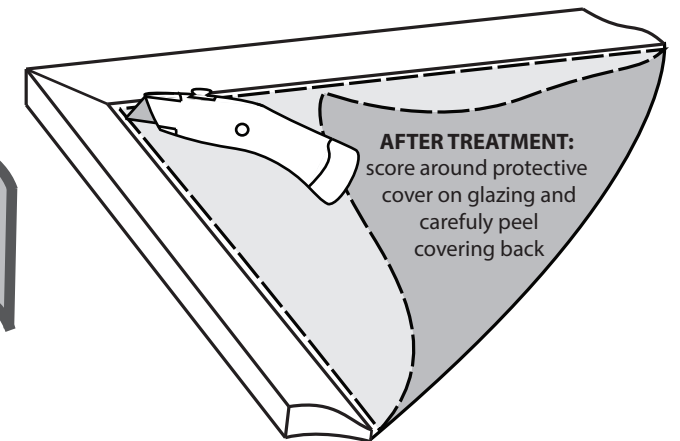

AFTER TREATMENT: score around protective cover on glazing and carefully peel covering back

Playhouse Maintenance:

It is recommended that the following checks and maintenance are carried out at the beginning of each season as well as at regular intervals during the usage season.

- Check all nuts /bolts/ screws for tightness and tighten when required.
- Check for movement / opening of wood giving rise to protrusion of nail heads and tips.
- Check hinges.
- Replace defective parts in accordance with the manufacturers instructions.
- Check any crossbeams, suspensions and anchors.
- If a swing is included; check the swing seat, chains and ropes.

IF THESE CHECKS ARE NOT CARRIED OUT THE ACTIVITY TOY COULD BECOME A HAZARD

DO NOT ALLOW YOUR CHILD TO PLAY WITH ANY COMPONENT PARTS PRIOR TO ASSEMBLY.