

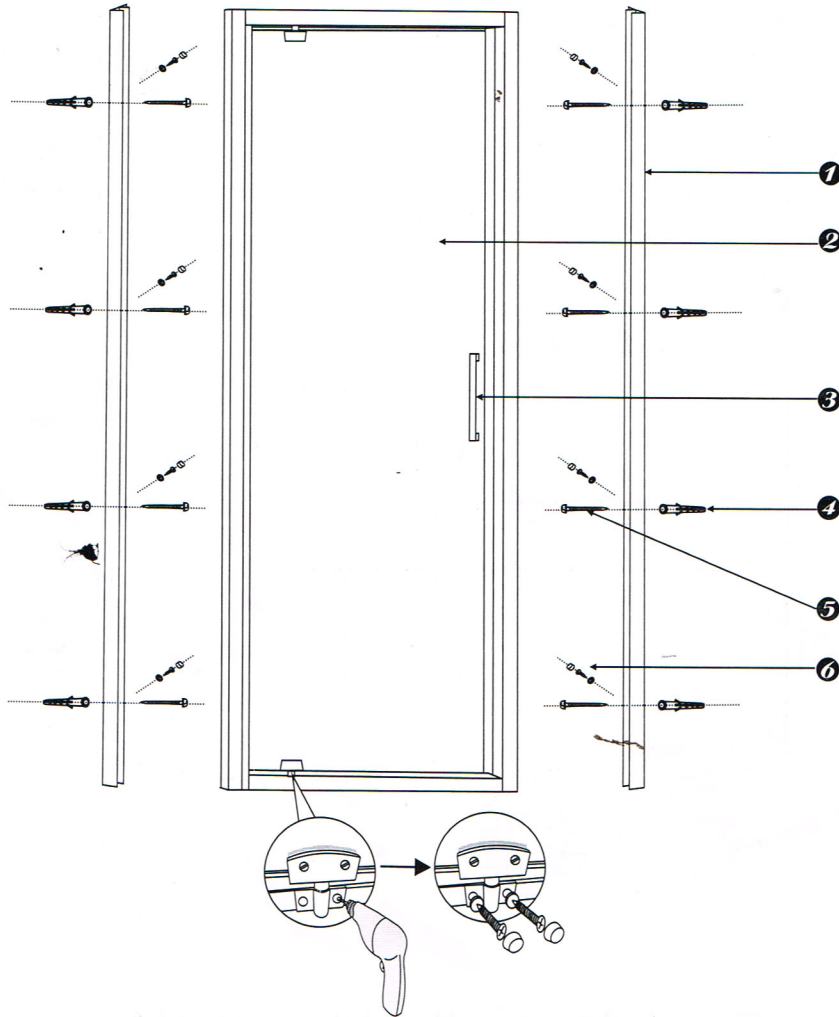

AquaLine Pivot Door Instruction Manual

SIZE:70x185cm 76x185cm 80x185cm 90x185cm



Pivot Door

- 1.wall profile
- 2.Pivot Door
- 3.Handle
- 4.Expandable wall plug
- 5.Screws 4x25
- 6.Screws 4x10

If installing on a tray, follow correct method of installation by installing the tray and tile down onto this.