

# USER MANUAL



Thank you for choosing Better Bathrooms.  
Please read this manual before installing your product  
and keep for future reference

better  
bathrooms

## Shower Arm

- Shower head supplied separately

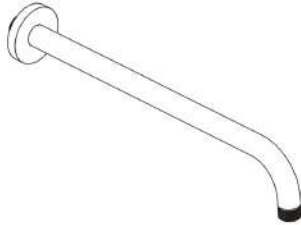

Please note: Image is for illustrative purposes only and may differ slightly to the actual product

- Single-person assembly
- We always recommend using professional tradespeople to install your product

V1\_05.11.2022

## Congratulations on your purchase

And welcome to our growing gang of savvy shoppers

We're on a mission to bring you extraordinary bathroom products, for less. From modern to traditional style ceramics, plus the gorgeous fixtures, fittings and furniture to match. So, you can fall in love with your space every single day.

As one of the UK's largest independent bathroom stores, we've received countless awards; including the National Business Awards UK, the Digital Entrepreneur Awards and being placed on The Sunday Times Fast Track 100.

We hope your new product exceeds your highest expectations. However, if you experience any problems, please:

- log in to your account and contact our customer services team via your self-serve portal [betterbathrooms.com/CustomerAccount/Login](https://betterbathrooms.com/CustomerAccount/Login).
- contact us via [betterbathrooms.com/content/contact-us](https://betterbathrooms.com/content/contact-us).

## Important information

- Please read these instructions thoroughly and retain for future reference.
- Manufactured to BS EN1112 Shower outlets for sanitary tapware.

## Parts

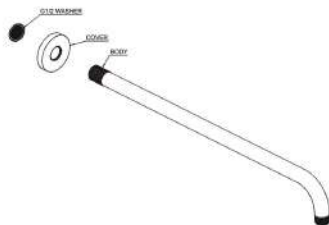

Please note that Parts are for illustrative purposes only and may differ slightly to the actual product

1. Body
2. Cover
3. Washer

## Installation

Please note: No tools are required

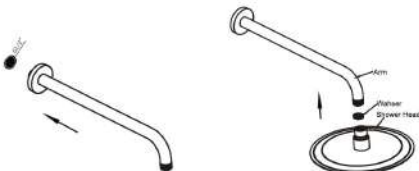

Step 1: Use sealant on the connector thread of the wall arm and then connect to the water supply.

Step 2: Screw the shower head to the wall arm.

## Troubleshooting

### Poor flow from shower head

1. This can be caused by poor water flow to the shower head, check the flow to the shower head.
2. There may be a blockage in the shower head, clean the shower head.

## Maintenance

- Remove the shower head and turn on the mixer. Check the flow of water, and if this is poor, it is not an issue with the shower head, and further investigation is required. Example: insufficient pressure in the system or blockage in the mixer or pipework.
- If your shower head has rubber nozzles, rub these with your finger to remove any blockage then turn on the shower, but do not shower immediately, allow the hand shower to flush through for 10 seconds.
- If the shower head does not have rubber nozzles and only has holes, brush the holes with a soft brush under warm running water to remove any blockage.
- Replace the shower head if the issue is not a pressure issue, blockage in the mixer and the shower head has been cleaned.

## Cleaning

To maintain the surface finish of your product, wipe clean after every use, using a clean damp cloth, a mild detergent mixture can be used. Do not use abrasive cleaning agents or materials on the product surface.

If any harsh chemicals come into contact with the surface of the product during bathroom cleaning, rinse off immediately, wipe clean and dry.

### For more information

- visit [betterbathrooms.com](https://betterbathrooms.com)
- email [customerservices@buyitdirect.co.uk](mailto:customerservices@buyitdirect.co.uk)
- call 03303903062
- write to Trident Business Park, Neptune Way, Huddersfield, HD2 1UA.

better  
bathrooms

Part of the BuyItDirect Group